

6" HI-CAPACITY AUGER SYSTEM

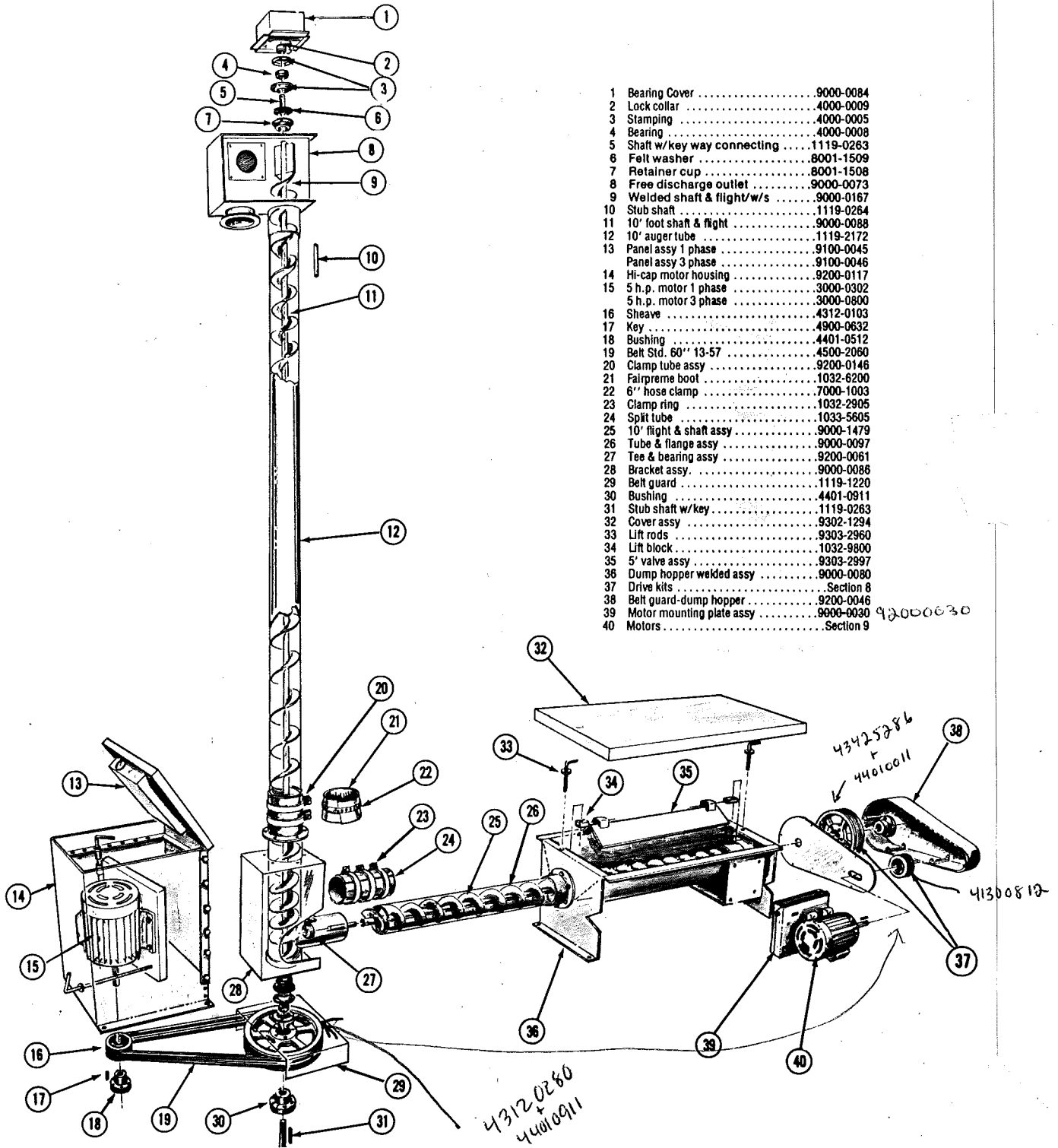

1	Bearing Cover	9000-0084
2	Lock collar	4000-0009
3	Stamping	4000-0005
4	Bearing	4000-0008
5	Shaft w/key way connecting	1119-0263
6	Felt washer	8001-1509
7	Retainer cup	8001-1508
8	Free discharge outlet	9000-0073
9	Welded shaft & flight/w/s	9000-0167
10	Stub shaft	1119-0284
11	10' foot shaft & flight	9000-0088
12	10' auger tube	1119-2172
13	Panel assy 1 phase	9100-0045
	Panel assy 3 phase	9100-0046
14	Hi-cap motor housing	9200-0117
15	5 h.p. motor 1 phase	3000-0302
	5 h.p. motor 3 phase	3000-0800
16	Sheave	4312-0103
17	Key	4900-0632
18	Bushing	4401-0512
19	Belt Std. 60" 13-57	4500-2060
20	Clamp tube assy	9200-0146
21	Falprame boot	1032-6200
22	6" hose clamp	7000-1003
23	Clamp ring	1032-2905
24	Split tube	1033-5605
25	10' flight & shaft assy	9000-1479
26	Tube & flange assy	9000-0097
27	Tee & bearing assy	9200-0061
28	Bracket assy	9000-0086
29	Belt guard	1119-1220
30	Bushing	4401-0911
31	Stub shaft w/key	1119-0263
32	Cover assy	9302-1294
33	Lift rods	9303-2960
34	Lift block	1032-9800
35	5' valve assy	9303-2997
36	Dump hopper welded assy	9000-0080
37	Drive kits	Section 8
38	Belt guard-dump hopper	9200-0046
39	Motor mounting plate assy	9000-0030
40	Motors	Section 9

43120286
44010911

43425886
44010911

41300812

92000030