

REVISION HISTORY				
REV	ECN	DESCRIPTION	DATE	APPROVED
A	K010075	RELEASE	9/19/2001	PGGALEA
B	K070147	REDRAWN INVENTOR	11/2/2007	DMJOHNSON
C	K070175	K201-00268 WAS 4 PCS	11/13/2007	PGGALEA
D	K080012	67254400 WAS 67324400	2/12/2008	DMJOHNSON
E	K110220	UNDO REV D	10/14/2011	jlmoss

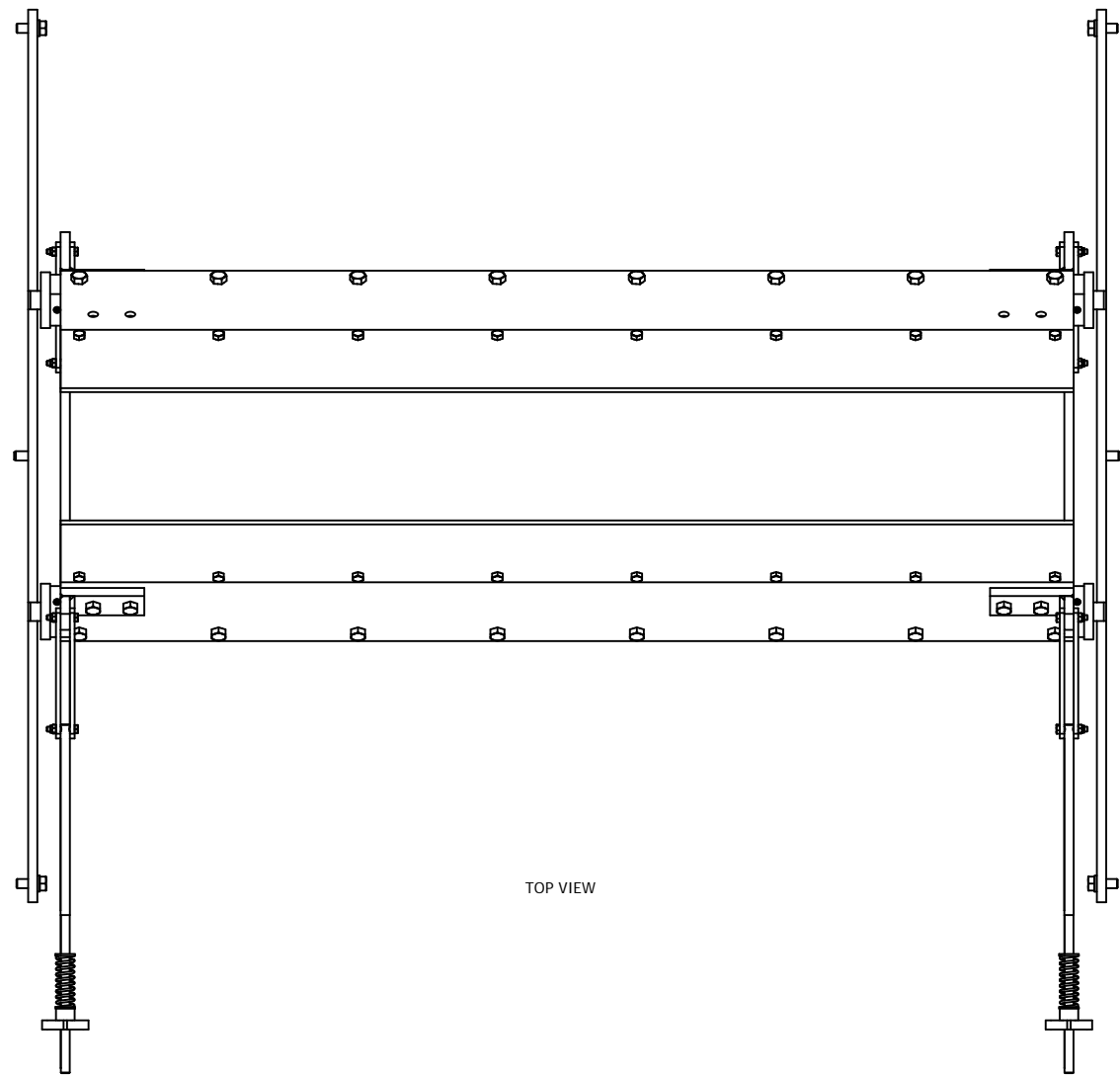

TOP VIEW

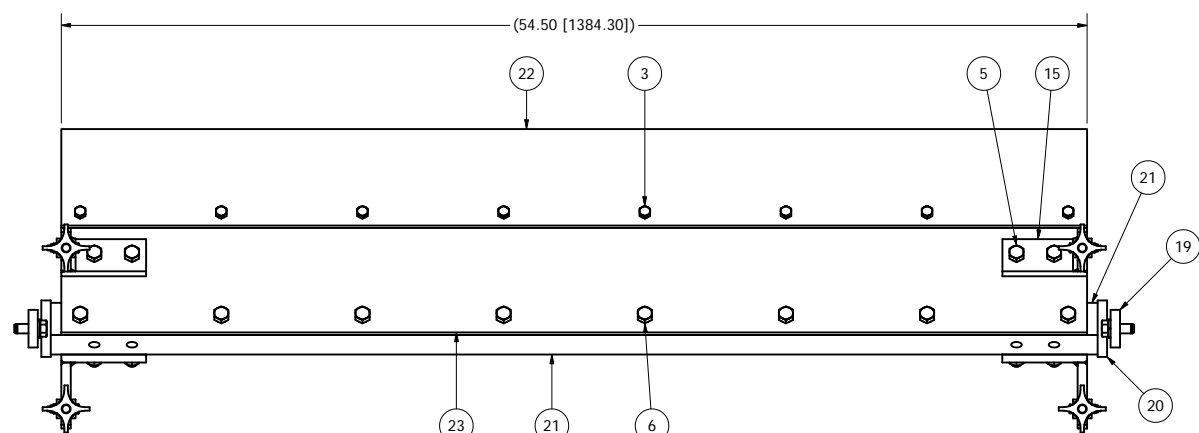

FRONT VIEW

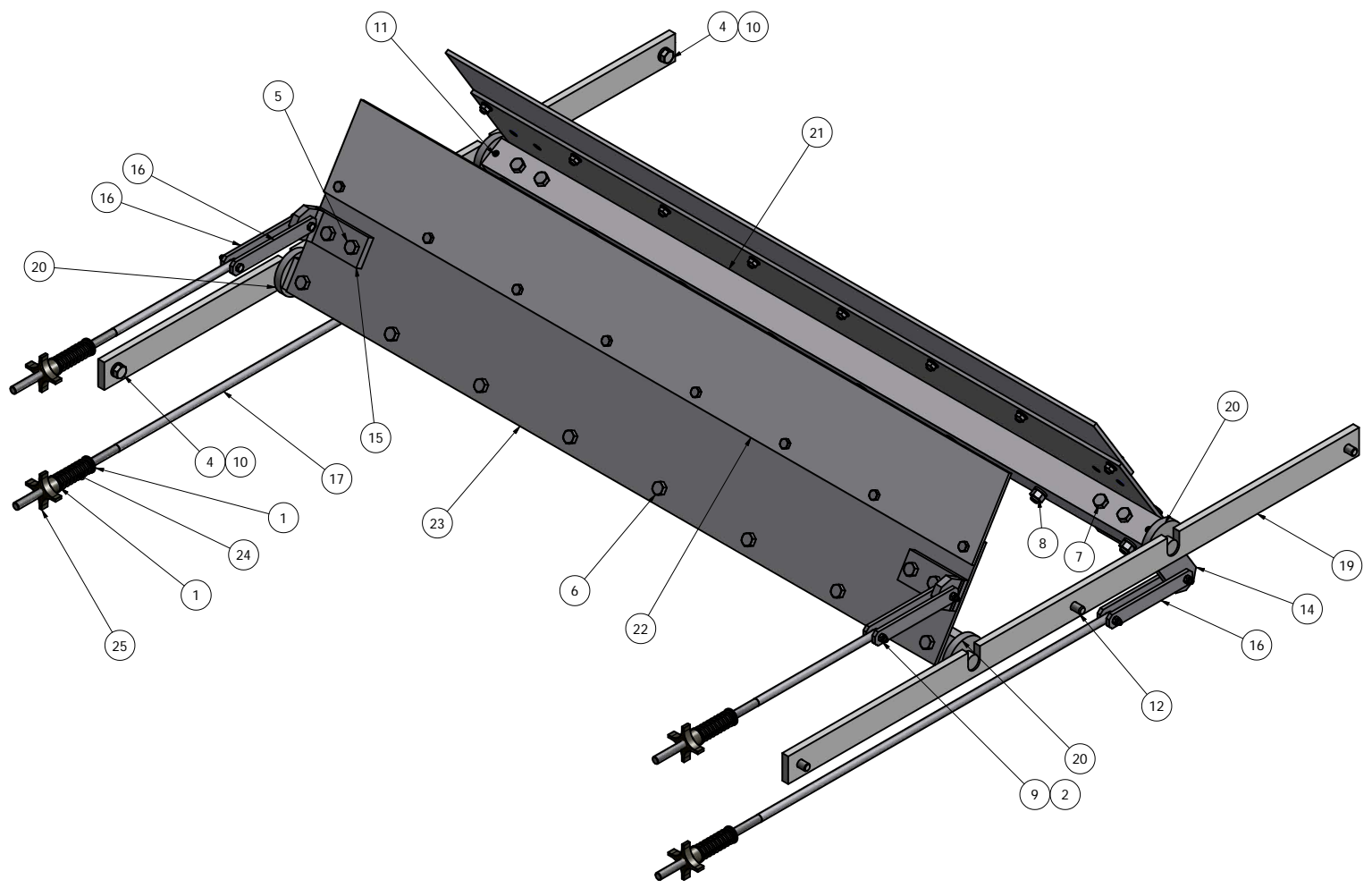

RIGHT SIDE VIEW

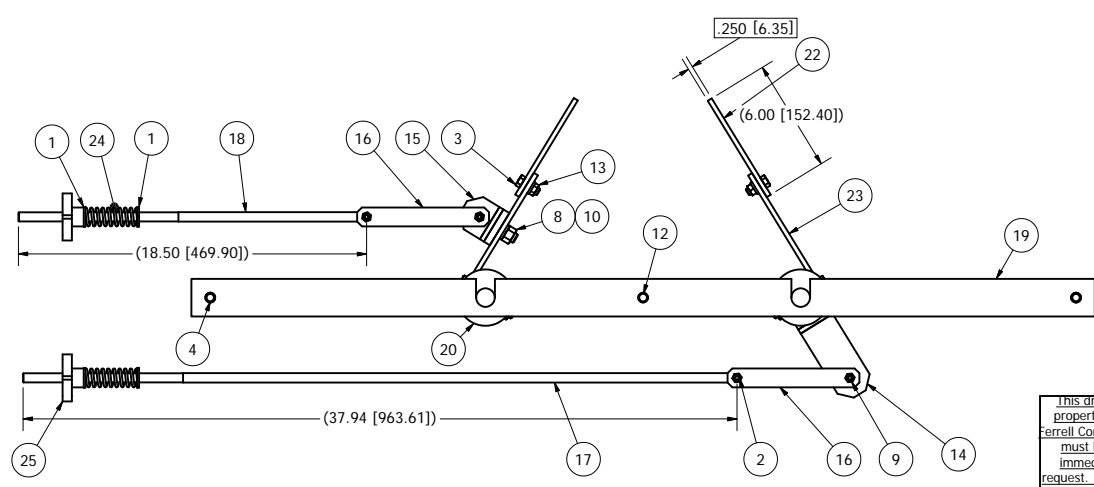

ITEM	PART NUMBER	QTY	DESCRIPTION
25	K910-01261	4	KNOB, CAST 1/2-13 OPEN
24	K201-00268	8	SPRING, SCRAPER TENSION 2.75"
23	K200-05863	2	PLT, SCRAPER BACKING FL 24 X 56"
22	K200-05862	2	BLADE, SCRAPER .25X6.00" ALUM 24X56"
21	K200-05861	2	BAR, SCRAPER FL 24 X 56"
20	K200-02274	4	END, SCRAPER BAR FL 24"
19	K200-02014	2	SUPPORT, SCRAPER 24" FL
18	K200-02013	2	ROD, FRONT TENSION, SCRAPER FL 24"
17	K200-02012	2	ROD, REAR TENSION, SCRAPER FL 24"
16	K200-02011	8	LINK, ROD, SCRAPER FL 24"
15	K200-02010	2	BRACKET WLDMT, UPR ROD, SCRAPER FL 24"
14	K200-02009	2	BRACKET WLDMT, LWR ROD, SCRAPER FL 24"
13	67324400	16	NUT, HEX SERR LOCK 18-8 SS, 3/8-16
12	67185226	2	SHCS, FLT CNTRSINK T304 SS 1/2-13X1.25"
11	67134408	4	SCW, SET 18-8 SS 3/8-16 X .38" SCKT KNLRD CUP PT
10	67125200	28	WASHER, LOCK HELICAL 18-8 SS, 1/2"
9	67093300	8	NUT, HEX 18-8 SS 1/4-20 NYLOCK
8	67065200	24	NUT, HEX 18-8 SS 1/2-13
7	67055244	4	HHCS, 18-8 SS, 1/2-13 X 3.25"
6	67055242	16	HHCS, 18-8 SS, 1/2-13 X 3.00"
5	67055228	4	HHCS, 18-8 SS 1/2-13 X 1.50"
4	67055226	4	HHCS, 18-8 SS 1/2-13 X 1.25"
3	67054422	16	HHCS, 18-8 SS 3/8-16 X 1.00"
2	67053328	8	HHCS, 18-8 SS, 1/4-20 X 1.50"
1	66405200	8	WASHER, FLAT 1/2" TYPE A

NOTES:  
 1. DO NOT SCALE FROM DRAWING.  
 2. ONE PIECE REQ'D PER K000-02456: ROLLER MILL ASSY, FL 24 X 56".  
 3. ONE PIECE REQ'D PER K000-02460: ROLLER MILL ASSY, RF/OS 24 X 56".  
 4. FOR 3/8" THICK SCRAPER BLADE SEE K200-05999: BLADE, SCRAPER 3/8" ALUM, 24 X 56".  
 5. APPLY A THIN EVEN COAT OF FOOD GRADE SS ANTI-SEIZE (FDA SPEC SECTION 178.3570) TO ALL SS MALE FASTNER THREADS BEFORE ASSEMBLYING.

This drawing is the property of the A.T. Ferrell Company, Inc. and must be returned immediately upon request. No part of this drawing may be reproduced, stored in a retrieval system or transmitted in any form or by any means, without prior written consent of the A.T. Ferrell Company, Inc.

**CAD**  
 NO MANUAL CHANGES TOLERANCES EXCEPT AS NOTED

DIVISION OF A. T. FERRELL COMPANY  
 SINCE 1867  
 BLUFFTON, INDIANA - USA

FINISH: NONE  
 SCALE: 1:5  
 DRAWN BY: pggalea  
 APPROVED BY: DMJ

TITLE: SCRAPER ASSY, FL/OS 24 X 56"  
 DATE: 11/1/2007  
 SIZE: D  
 PART NUMBER: K100-02416  
 SHEET: 1 of 1