

REVISION HISTORY				
REV	ECN	DESCRIPTION	DATE	APPROVED
A	F110172	RELEASE	9/8/2011	dmjohnson

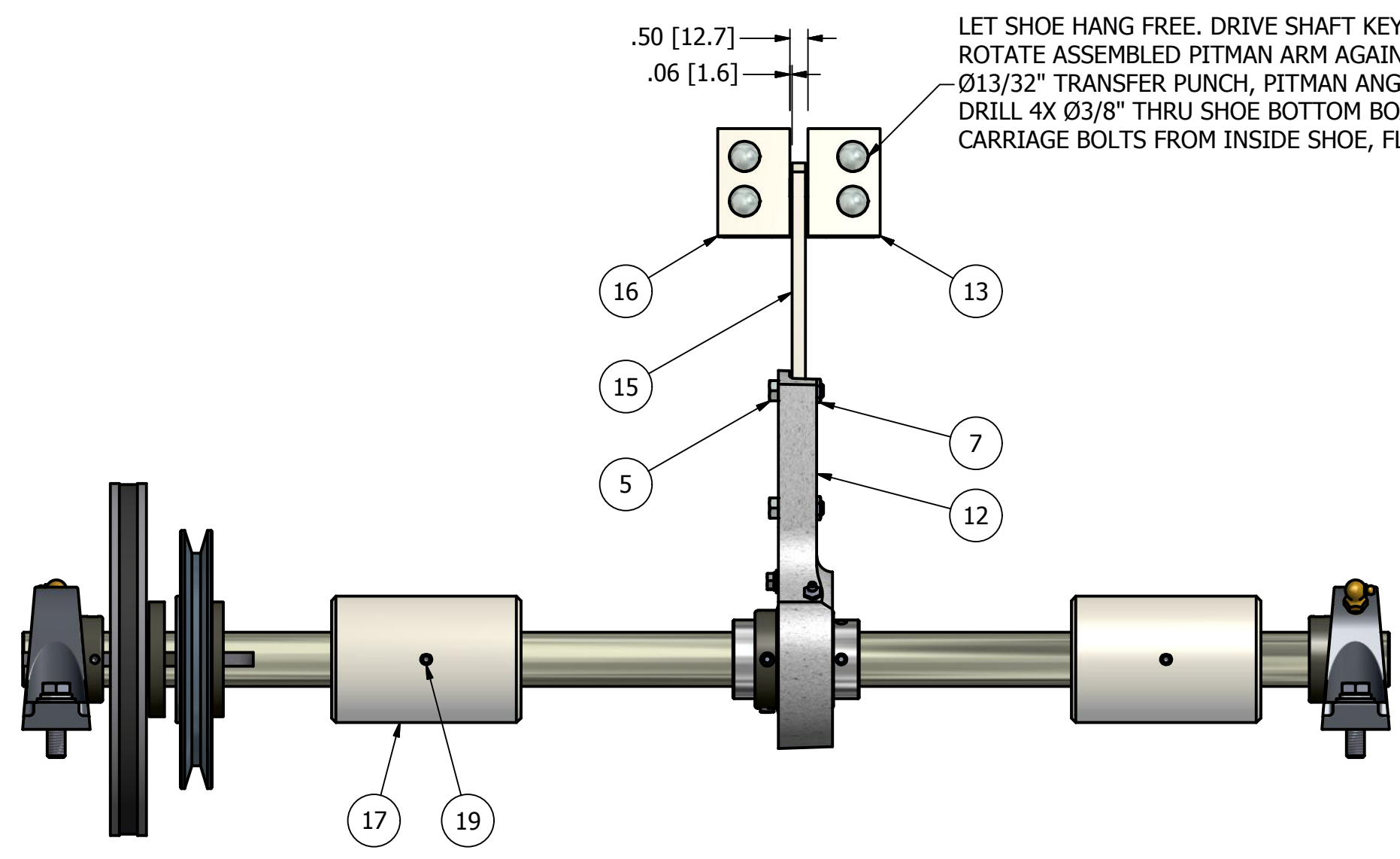

LET SHOE HANG FREE. DRIVE SHAFT KEYWAY @ 90° AS SHOWN.  
 ROTATE ASSEMBLED PITMAN ARM AGAINST SHOE BOTTOM BOARD.  
 Ø13/32" TRANSFER PUNCH, PITMAN ANGLE HOLES' LOCATION INTO BOARD.  
 DRILL 4X Ø3/8" THRU SHOE BOTTOM BOARD & BOTTOM METAL. DRIVE  
 CARRIAGE BOLTS FROM INSIDE SHOE, FLUSH W/SHOE BOTTOM METAL.

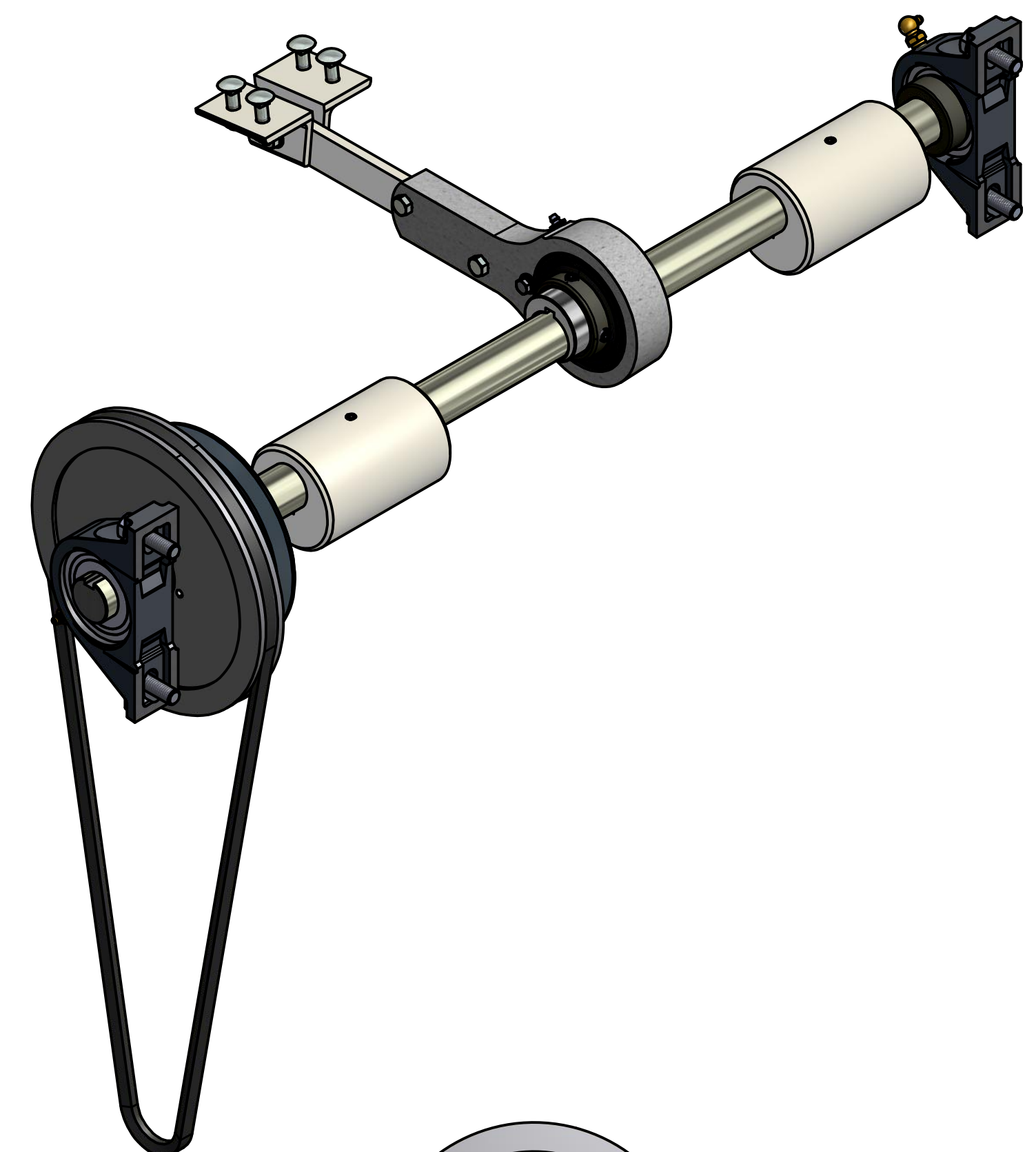
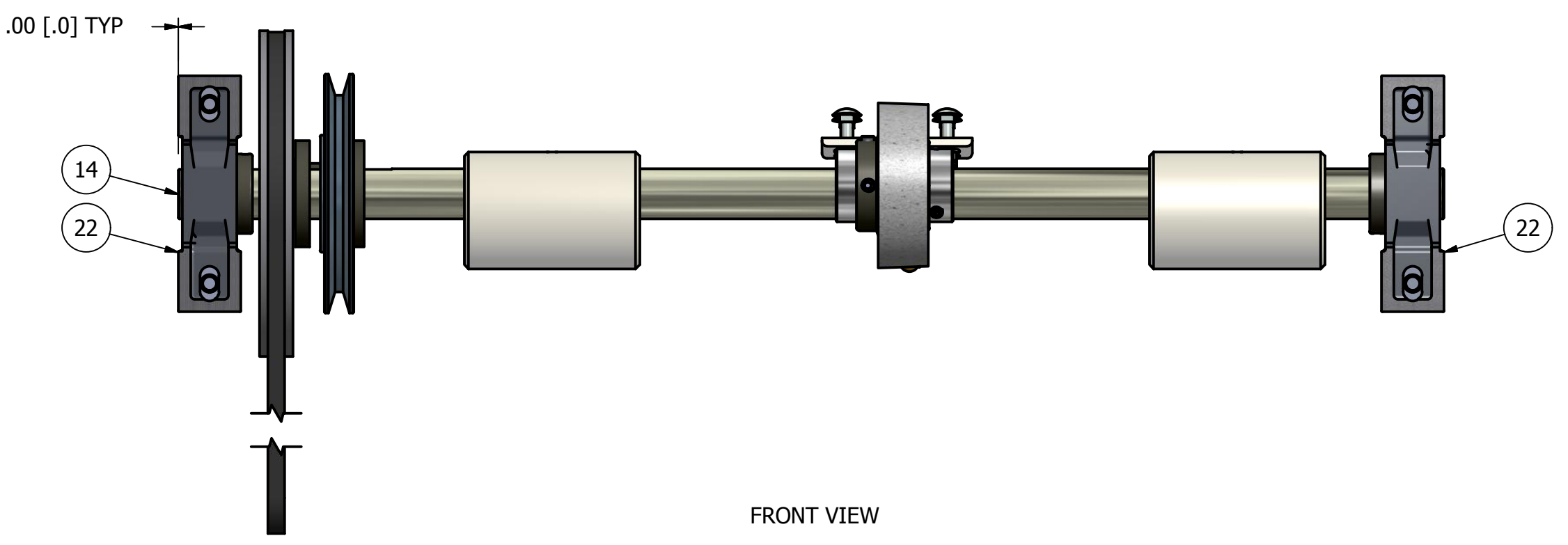
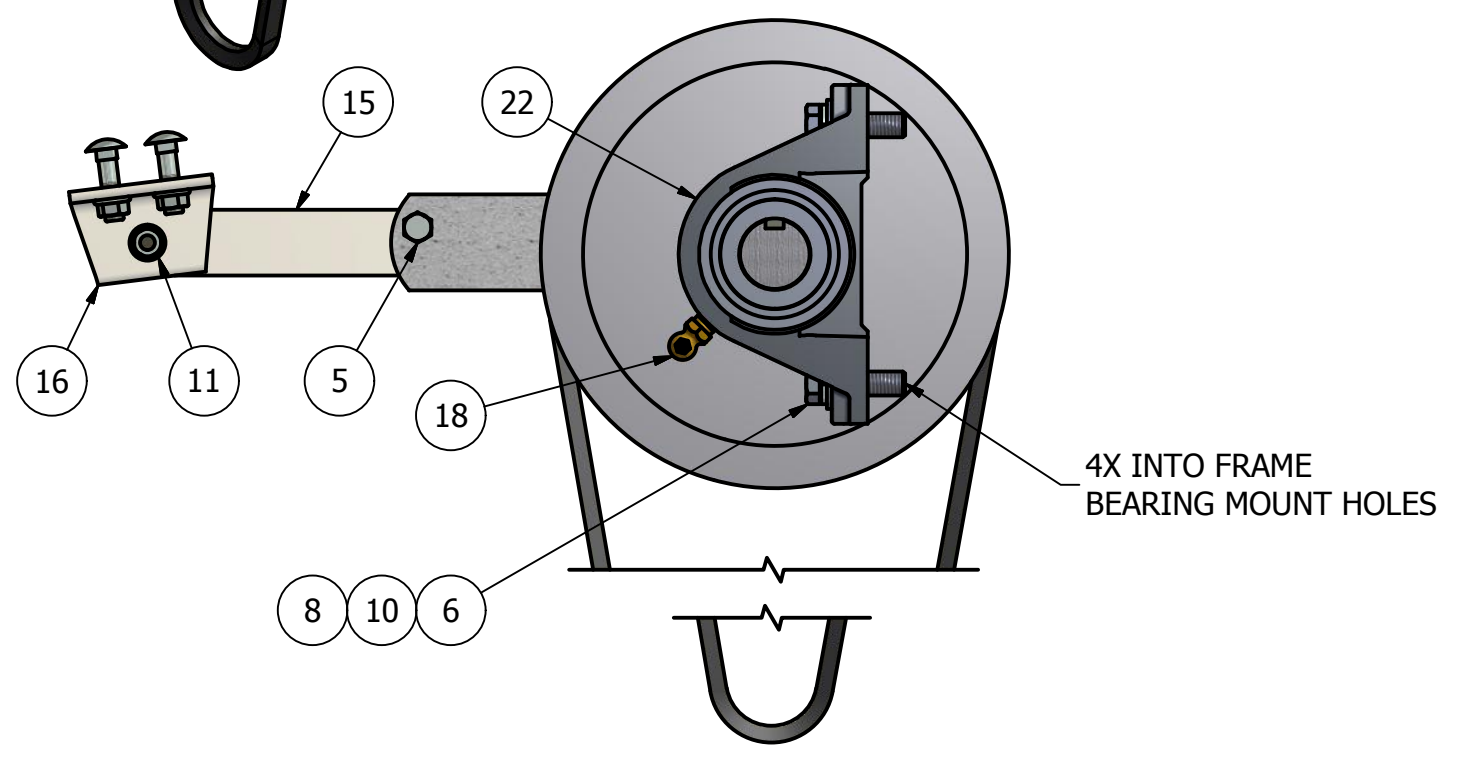
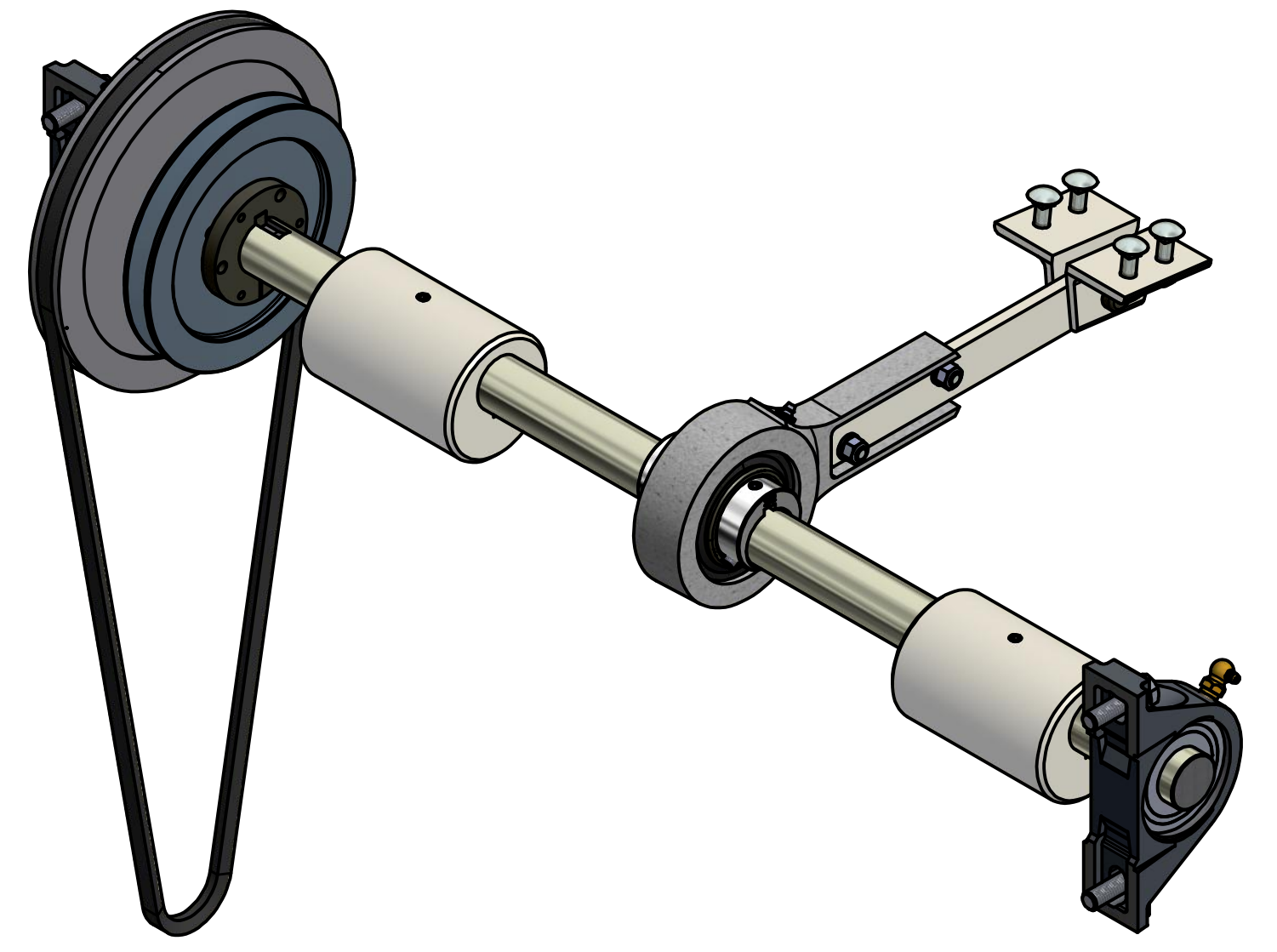

FRONT VIEW

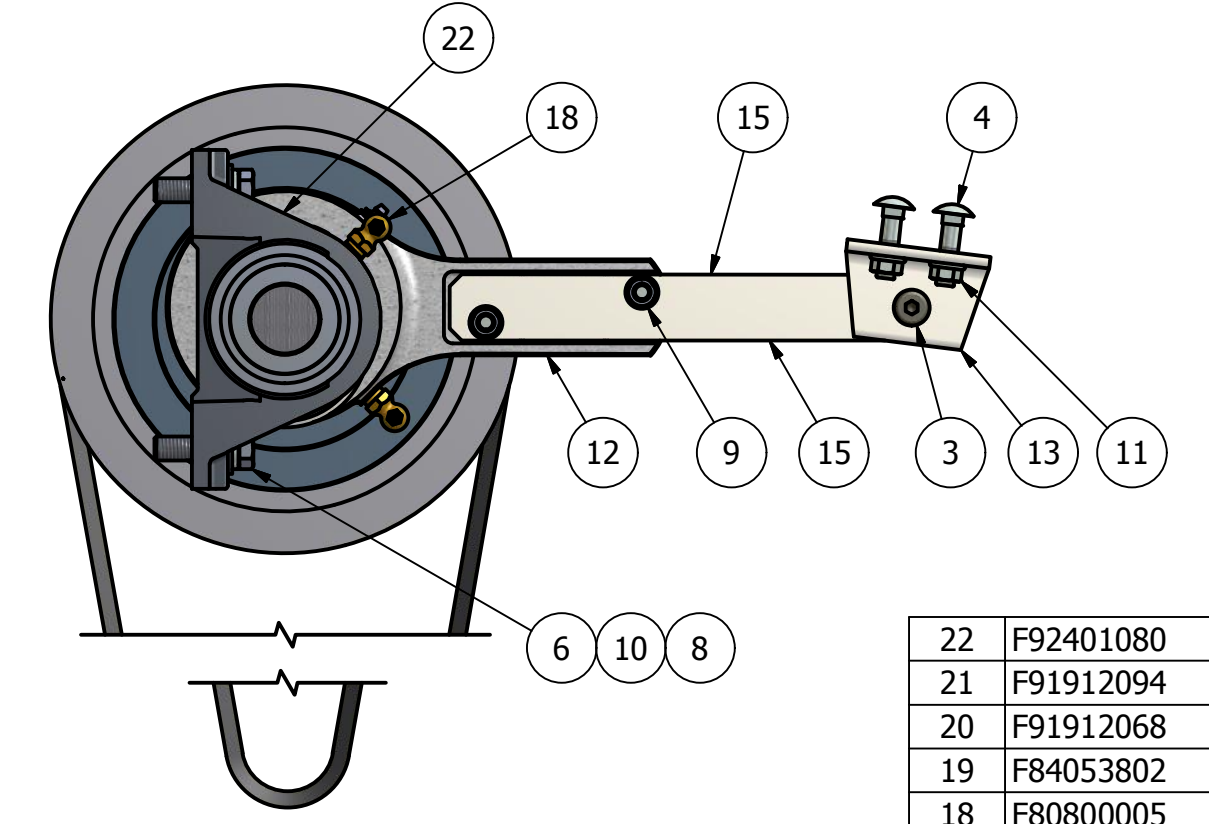

ITEM	PART NUMBER	QTY	DESCRIPTION
22	F92401080	2	BEARING, PB 1.500" VAK
21	F91912094	1	SHEAVE, 1B 9.4 SDS
20	F91912068	1	SHEAVE SDS 1B6.8
19	F84053802	2	SCW, SET 3/8-16 X 1/2" KNURL CUP
18	F80800005	2	FITTING, GREASE 90 DEG, 1/4 NPT
17	F60000016	2	COUNTERWEIGHT, ECLIPSE 324
16	F60000013	1	PITMAN ANGLE, ECLIPSE
15	F60000012	1	ARM, PITMAN, ECLIPSE
14	F60000011	1	SHAFT, ECCENTRIC, ECLIPSE 324
13	F19804702	1	PITMAN ANGLE, X298D
12	F19503600	1	ECCENTRIC ASSY, .500" THROW, 1.500" BORE
11	66784400	5	NUT, HEX SERR LOCK 3/8-16
10	66445200	4	WASHER, LOCK HELICAL 1/2"
9	66444400	2	WASHER, LOCK HELICAL 3/8"
8	66405200	4	WASHER, FLAT 1/2" TYPE A
7	66084400	2	NUT, HEX 3/8-16
6	62585230	4	HHCS, 1/2-13 X 1.75"
5	62584426	2	HHCS, 3/8-16 X 1.25"
4	60284428	4	BOLT, CARR 3/8-16 X 1.50"
3	60265243	1	BOLT, SHLDR, HX SCKT HD .500X.75X3/8-16
2	45010058	1	BELT, V, 4L580
1	44010518	2	BUSHING, QD SDS 1.500"

- NOTES:  
 1. DO NOT SCALE FROM DRAWING.  
 2. ONE PIECE REQUIRED PER F60000000/20: CLEANER ASSY, RH/LH, ECLIPSE 324.  
 3. ALTERNATIVE DIMENSIONS [X.X] IN MILLIMETERS.  
 4. TORQUE BUSHING SCREWS TO 9 FT-LBS/1.24 KG-M/12.20 NEWTON-M.

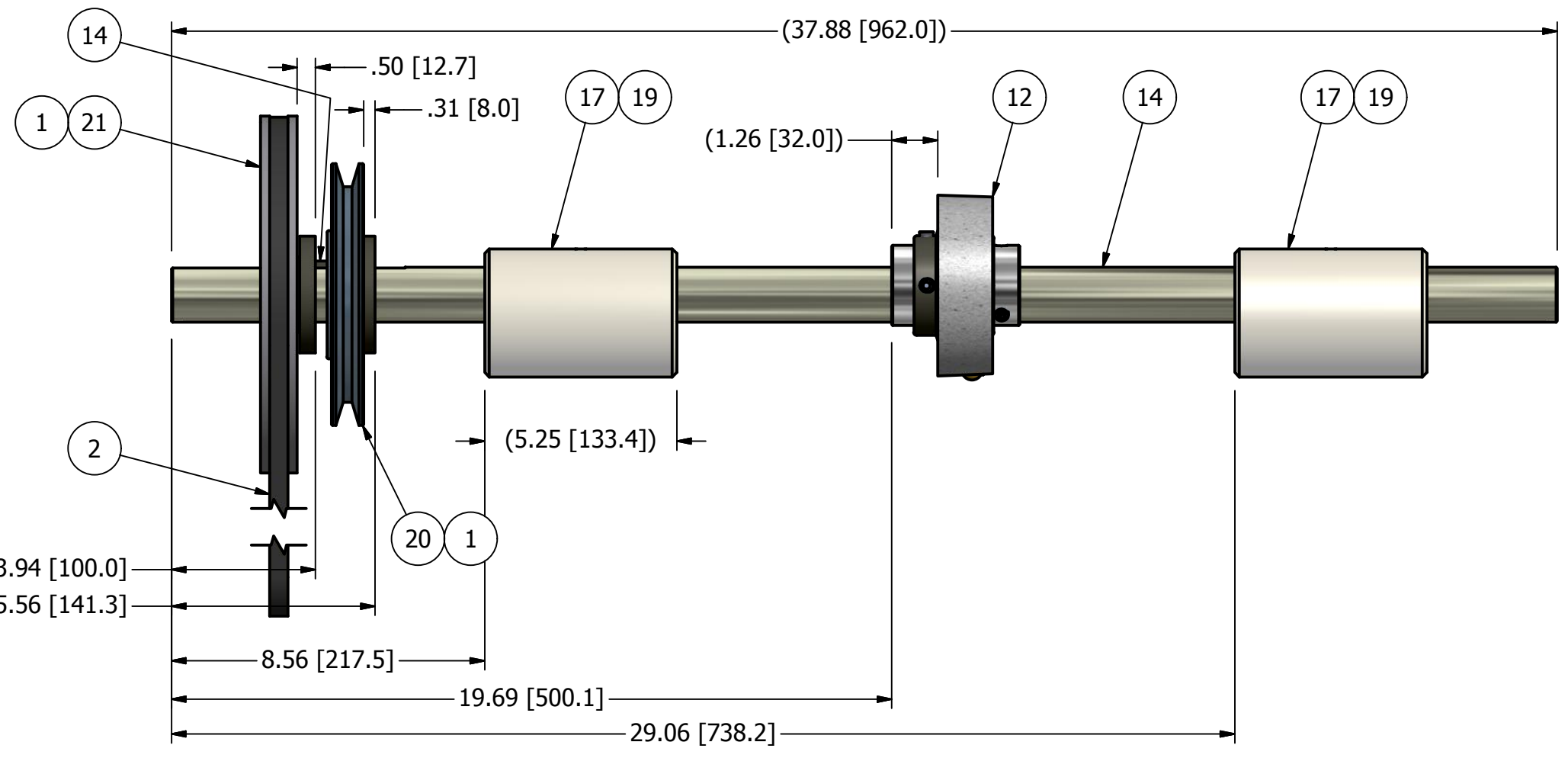

FRONT VIEW: SHAFT ASSEMBLY

**CLIPPER** SEPARATION TECHNOLOGIES SINCE 1869

**DIVISION OF A.T. FERRELL COMPANY**  
 1440 S ADAMS ST  
 BLUFFTON, INDIANA 46714 - USA  
 PH: 260-824-3400  
 FAX: 260-824-5463

This drawing is the property of the A.T. Ferrell Company, Inc. and must be returned immediately upon request. No part of this drawing may be reproduced, stored in a retrieval system or transmitted in any form or by any means, without prior written consent of the A.T. Ferrell Company, Inc.

DRAWN BY: dmjohnson  
 DRAWN DATE: 9/8/2011  
 APPROVED BY: DMJ

TOLERANCES EXCEPT AS NOTED:  
 DECIMAL: FRACTIONAL:  
 .XX ± .030 ± 1/32  
 .XXX ± .005 ± 1/64  
 .XXXX ± .001 ± 1/128

FINISH: NONE  
 ANGLAR: ± 1/2°

TITLE: ECCENTRIC ASSY, RH, ECLIPSE 324

CAD NO MANUAL CHANGES SCALE: 1:4 SHEET: 1 OF 1 SIZE: D PART NUMBER: F60000010 REV: A